



City of Banning

Trash Enclosure Roof Structure

Banning Building Department 99 E. Ramsey St. Banning, Ca.

2/13/2025 By Brian Gumpert Alternate designs or installations not listed here require design engineering analysis specific to your site criteria. No geotechnical reports are required.

Trash enclosures must be covered in MS4 watershed zone. Design is for wood structure only with metal roofing. Allumawood design may be used with manufacturers specifications above ground. Steel designs require engineered plans. Deviations or alterations from plans require engineered plans and stamp.

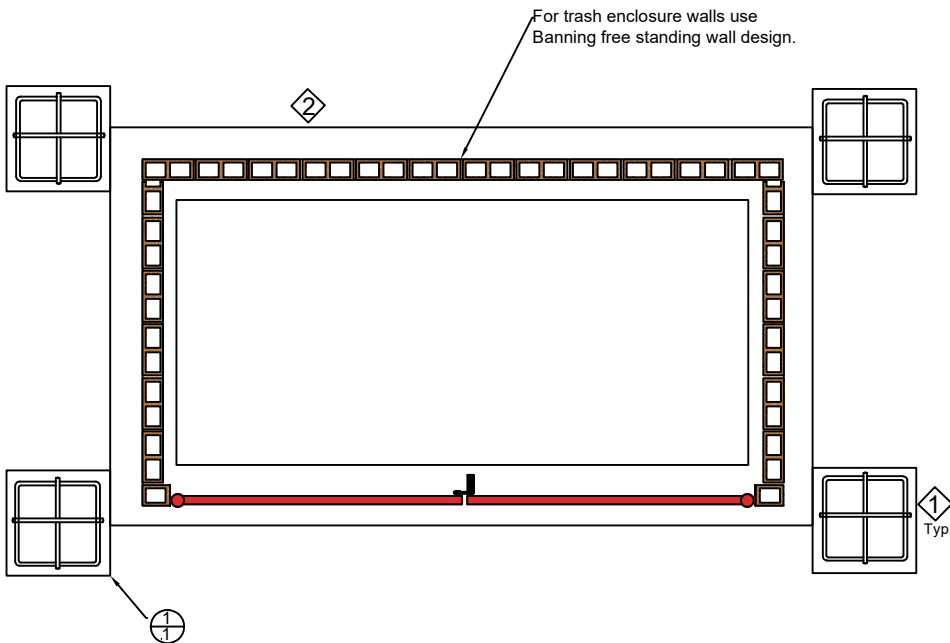

Beam Sizing			
Trib width	Beam Size	Trib width	Beam Size
5 ft.	4 x 8 Struct #1	10 ft.	4 x 12 PSL ext.
6 ft.	4 x 10 Struct #1	11 ft.	4 x 12 PSL ext.
7 ft.	4 x 12 Struct #1	12 ft.	4 x 14 PSL ext.
8 ft.	4 x 14 Struct #1	13 ft.	4 x 16 PSL ext.
9 ft.	6 x 12 (6" posts)	14 ft.	6 x 14 PSL ext.

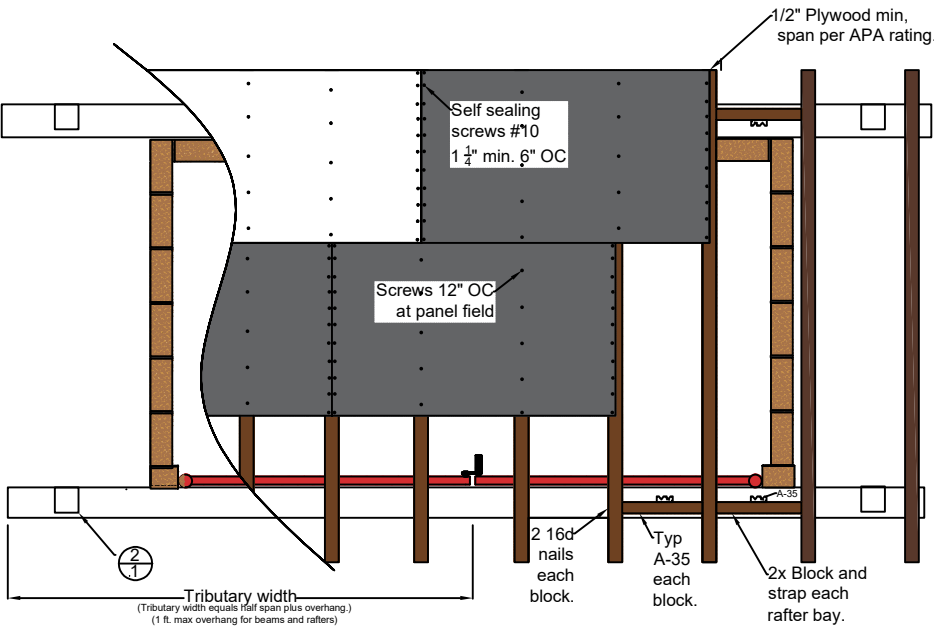

- 1 Cube footing see Table A
- 2 Wall footing see wall structural

TABLE A

Trib width	Post Height		
	8'	12'	15'
5'	21 ci	30 ci	34 ci
6'	27 ci	34 ci	36 ci
7'	31 ci	34 ci	36 ci
8'	34 ci	37 ci	41 ci
9'	37 ci	41 ci	44 ci
10'	37 ci	41 ci	44 ci
11'	39 ci	44 ci	46 ci
12'	40 ci	46 ci	48 ci

Footing size in cubic inches

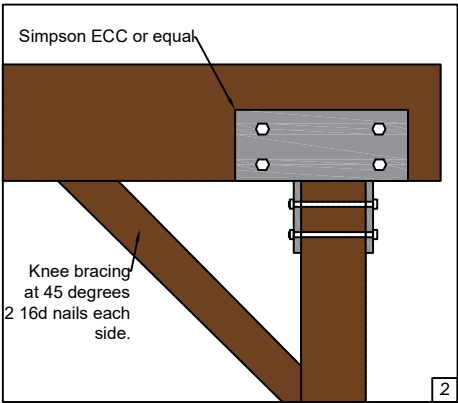
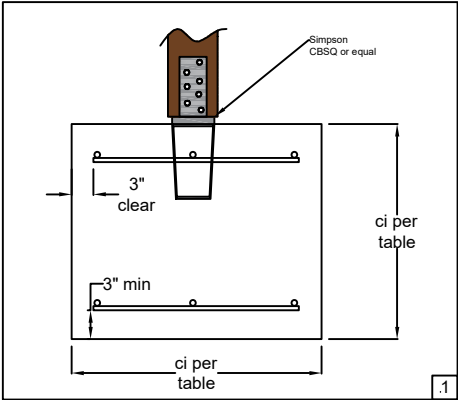

Rafter Sizing	
7 ft. Span	2 x 4 @16" OC
9 ft.	2 x 6 @ 24" OC
10 ft.	2 x 6 @ 16" OC
12 ft.	2 x 8 @ 16" OC
15 ft.	2 x 10 @16" OC
12 ft.	4 x 6 @24" OC
15 ft.	4 x 8 @24" OC
18 ft.	4 x 10 @24" OC

Roofing must be corrugated steel, rolled form steel or aluminum. 30 lbs underlayment is required with drip edge.